

TOOLS 4 INDUSTRY

WWW.T4I.COM.AU

DRILLS AND ACCESSORIES

Portable Magnetic Drilling Units

Model CODE	HFLP-35 D9506	HF-35 D950	HF-50 D9508	HF-750 D9507
Feed	Manual	Manual	Manual	Manual
Drilling Capacity Range	mm 12-35	mm 12-35	mm 12-50	mm 12-75
Maximum Thickness	mm 35	mm 50	mm 50	mm 50
Suits Cutter Shank Size	mm 19	mm 19	mm 19	mm 19
No. of Drilling Speeds	1	1	2	4
Full Load Drilling Speeds	rpm 390	rpm 350	rpm 180 / 270	rpm 90, 120, 180, 230
No. Load Drilling Speeds	rpm 650	rpm 620	rpm 300 / 450	rpm 150, 200, 300, 380
Magnetic Holding	kg/f 1500	kg/f 1529	kg/f 1733	kg/f 3263
Motor Power	kW / hp 1.1 / 1.46	kW / hp 1.1 / 1.46	kW / hp 1.1 / 1.46	kW / hp 1.8 / 2.4
Voltage / Amperage	V / amp 240 / 10	V / amp 240 / 10	V / amp 240 / 10	V / amp 240 / 10
Weight	kg 14	kg 17.5	kg 17.5	kg 31
PRICE	inc GST \$979	inc GST \$990	inc GST \$1,309	inc GST \$1,859

Includes

- Chip Guard (HFLP-35)
- Safety Chain (HF-35/50/750)
- Coolant Tank Kit (HF-35/50/750)
- Blow Moutl Plastic Case

- ✓ CE Approved
- ✓ Compact Design
- ✓ Heavy Duty Magnet

HF-750

- 3MT spindle with broach cutter
- Forward/reverse tapping
- Ø75mm drilling capacity through 50mm plate

HFLP-35

- Quick release handle, left or right hand
- LED work light
- Safety strap



HF-35

- Includes Ø13mm drill chuck & adaptor



HF-50

- 2 x drilling speed selection



Bench & Pedestal Drilling Machines

- Drilling machines include: Safety micro switch on pulley guard, drill chuck & arbor

Pedestal Drill (D592) Bench Drill (D590)

- 1hp 240V motor
- 12-speed 2MT
- 16mm drill capacity
- A Section belt drive



BD-325 D590

\$330
inc GST

Pedestal Drill (D594) Bench Drill (D594)

- 1hp 240V motor
- 12-speed 2MT
- 20mm drill capacity
- A Section belt drive



BD-360 D594

\$429
inc GST

Pedestal Drill (D598)

- 1.5hp 240V motor
- 12-speed 3MT
- 28mm drill capacity
- A Section belt drive



Industrial Pedestal

- 1hp 240V motor
- 9-speed 3MT
- 31.5mm drill capacity
- B-Section belt drive



Made in Taiwan



PD-325 D592

\$374
inc GST

PD-360 D596

\$473
inc GST

PD-440 D598

\$792
inc GST

DP-35 D162

\$1,529
inc GST

Geared Head Drill

GHD-22

- 31.5mm drilling capacity
- 3MT spindle taper
- 105-2900rpm speeds
- 350 x 500mm work table
- 0.9kW / 1.2hp, 415V motor
- Includes drill chuck & arbor



GEARED HEAD
31.5MM CAPACITY

D170

\$2,365
inc GST

Geared Head Drill

GHD-32

- 40mm drilling capacity
- 4MT spindle taper
- 95-3200rpm speeds
- 490 x 460mm work table
- 1.5kW / 2hp, 415V motor
- Includes coolant pump system & drill chuck



GEARED HEAD
40MM CAPACITY

D177

\$3,179
inc GST

Pedestal Mill Drill

DMF-42

- 3MT spindle, 6 speeds
- 585 x 190mm work table
- 370 x 175mm table travels
- Micro down feed adjustment
- 1.1kW / 1.5hp 240V
- Includes drill chuck & face milling cutter



GEARED HEAD
& TILTING HEAD

D181A

\$2,805
inc GST

Drill Chuck Arbors

- Precision ground and tapered



TM TOOLMASTER

Capacity	CODE	inc GST
2MT x JT6	D442	\$17.05
2MT x JT3	D442A	\$17.05
3MT x JT6	D443	\$22.00
3MT x JT3	D443A	\$22.00
3MT x JT4	D455	\$30.25
4MT x JT6	D454	\$30.25
4MT x JT3	D454A	\$30.25
4MT x JT4	D456	\$30.25

Morse Taper

- Hardened and precision ground



TM TOOLMASTER

Capacity	CODE	inc GST
2MT x 1MT	D420	\$12.10
3MT x 2MT	D422	\$18.15
4MT x 2MT	D423	\$24.20
4MT x 3MT	D424	\$26.40
5MT x 4MT	D425	\$58.30

Keyed Drill Chucks - Heavy Duty

- Robust design
- Supplied with chuck key

Capacity	Mount	CODE	inc GST
0.5-13mm	JT6	C289	\$59.40
0.5-16mm	JT3	C290	\$82.50



Keyed Drill Chucks - Industrial - Heavy Duty

- Superior gripping
- Precision manufactured

Capacity	Mount	CODE	inc GST
0.3 - 13mm	JT6	C292	\$108.90
3-16mm	JT3	C294	\$133.10



Drilling Vices

V126



Size	Type	CODE	inc GST
100mm	Standard	V124	\$27.50
127mm	Standard	V125	\$42.90
152mm	Standard	V126	\$49.50
100mm	Tilting	V114	\$79.20

Drill Press Vice

- Manufactured from close grain cast iron
- The Deluxe Vice comes with jaws that are hardened with vertical & horizontal grooves for prismatic work



TM TOOLMASTER

Size	CODE	inc GST
100mm	V144	\$93.50

Compound Drill Vices

- Cast iron body
- Adjustable slides

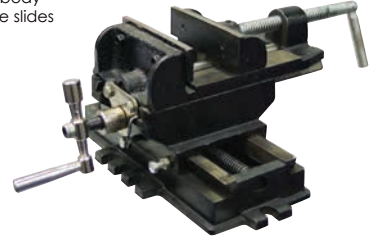

Size	Travel	CODE	inc GST
105mm	114 x 102mm	V120	\$77
150mm	203 x 152mm	V122	\$121

Gravity Feed Coolant System

CB-2

- Includes:
 - 2 x 1 litre plastic bottles
 - Flex hose nozzle
 - Flow control valve
 - 2 x support brackets



CODE	inc GST
P220	\$29.70



Shown Assembled

Reversible Tapping Chucks

TM TOOLMASTER

- Suitable for all drilling and milling machines for small production runs
- Cushioned drive prevents thread distortion & cross threading

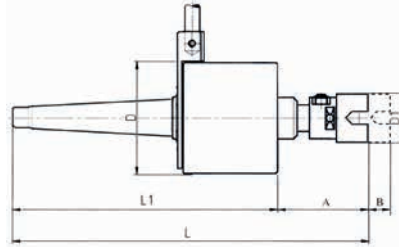

UNITS (mm)

Model	Tapping	Taper	D	D1	L	L1	A	B	Weight kg	CODE	inc GST
K2-MT2	M5 - M10	2MT	95	34	230	165	65	11	1.82	T002	\$181.50
K3-MT3	M6 - M14	3MT	117	38	270	195	75	13	3.26	T003	\$211.75



T002

Drill Drift - Fully Hardened

- Black Oxidised

TM TOOLMASTER

Capacity	Length	CODE	inc GST
2MT x 3MT	140mm	D415	\$9.90
3MT x 4MT	160mm	D416	\$13.20
4MT x 5MT	170mm	D417	\$17.60



Optional Accessories

BROACH CUTTERS - HSS

- For Portable Magnetic Drilling Units
- 19mm weld-on type shank

TM TOOLMASTER

25mm drill length				50mm drill length			
SIZE	CODE	inc GST		SIZE	CODE	inc GST	
12mm	D9512	\$38.50		14mm	D9550	\$44.55	
13mm	D9513	\$38.50		16mm	D9552	\$47.30	
14mm	D9514	\$38.50		18mm	D9554	\$50.60	
16mm	D9516	\$38.50		20mm	D9556	\$59.40	
17mm	D9517	\$38.50		22mm	D9558	\$66.55	
18mm	D9518	\$38.50		24mm	D9560	\$71.50	
20mm	D9520	\$42.35		25mm	D9562	\$78.65	
22mm	D9522	\$48.40		26mm	D9564	\$78.65	
23mm	D9523	\$48.40		28mm	D9566	\$84.70	
24mm	D9524	\$54.45		30mm	D9568	\$90.75	
25mm	D9525	\$56.65		32mm	D9570	\$95.70	
26mm	D9526	\$56.65		34mm	D9572	\$102.85	
28mm	D9528	\$59.40		35mm	D9574	\$107.80	
30mm	D9530	\$62.70					
32mm	D9532	\$66.55					
34mm	D9534	\$71.50					
35mm	D9535	\$73.70					



Broach Drill Set

TM TOOLMASTER

- 6 Piece - High speed steel
- 14, 16, 18, 20, 22 & Ø24mm
- 25mm depth of cut
- 19mm shank size
- 1 x 6.35mm (1/4") locating pin

CODE	inc GST
D109	\$209



Drill Chuck & Adaptor

- Suits Models: HF-35 & HF-30A
- 13mm drill chuck with chuck key

CODE	inc GST
D9501	\$84.70



Broach Cutter Adaptor

- Quick Release Chuck
- Suits Models: HF-35 & HF-30A
- Suits 19mm shank broach drill cutters

CODE	inc GST
D9504	\$107.80



Drill Sharpener

EDBD-13

- Tough plastic construction
- CBN grinding wheel
- Split point
- 80W, 240V motor



Capacity	Uses	Weight	CODE	inc GST
3-13mm Metric 1/8"-1/2" Imperial	Single chuck	5kg	D070	\$99