

# TOOLS4INDUSTRY

WWW.T4I.COM.AU

## JAWS AND VICES

### Plastic - Soft Jaws

- Protects work piece from scoring or marking
- Magnetic back holds jaws in place (V054 & V0542)
- Magnetic strip holds jaws in place (V0544 & V0546)
- Supplied as a pair

#### TM TOOLMASTER

Size	Face Type	CODE	inc GST
100mm	Standard Serrated	V054	\$13.20
150mm	Standard Serrated	V0542	\$17.05
100mm	Multigrip	V0544	\$13.20
150mm	Multigrip	V0546	\$17.05

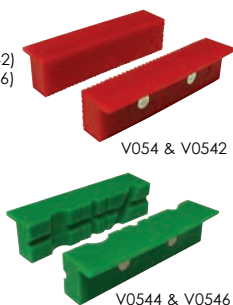

### Aluminium - Soft Jaws

- Protects work piece from scoring or marking
- 2 Magnetic tabs holds jaws in place
- Supplied as a pair

#### TM TOOLMASTER

Size	Face Type	CODE	inc GST
100mm	Aluminium Face	V053	\$13.20
125mm	Aluminium Face	V0531	\$14.30
150mm	Aluminium Face	V0532	\$17.05
100mm	Aluminium Prism Face	V0537	\$13.20
125mm	Aluminium Prism Face	V0538	\$14.30
150mm	Aluminium Prism Face	V0539	\$17.05
100mm	Rubber Face	V0534	\$13.20
125mm	Rubber Face	V0535	\$14.30
150mm	Rubber Face	V0536	\$17.05



### Bench Vices - Cast Iron

- Manufactured from nodular cast iron, and comes fitted with serrated jaws
- Acme screw thread

#### TM TOOLMASTER

Jaw Width	Weight	CODE	inc GST
100mm	11.5kg	V088	\$71.50
127mm	17kg	V089	\$104.50
152mm	23kg	V090	\$154.00

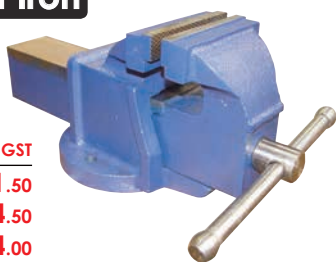

### Multi Purpose Vice

- MPV-12 - Cast Iron
- 125mm jaw width
- Swivel head & base
- Includes anvil & pipe jaws

CODE	inc GST
V075	\$187



### Compound Drill Vices

- Heavy duty fine grain cast iron compound drill vice
- 0.1mm graduation on dials

#### TM TOOLMASTER

Jaw Width	Travel	CODE	inc GST
105mm	100 x 100mm	V1204	\$121
125mm	125 x 125mm	V1205	\$198



### Deluxe - Drill Press Vices

- Hardened prismatic jaws
- Manufactured from close grain cast iron

#### TM TOOLMASTER

Jaw Width	Jaw Opening	Jaw Depth	CODE	inc GST
100mm	93mm	30mm	V144	\$93.50
127mm	120mm	30mm	V145	\$110.00



### Offset Fabricated Vices - Steel

- Fabricated from steel plate and designed for heavy duty work

#### TM TOOLMASTER

Jaw Width	Open	Weight	CODE	inc GST
100mm	125mm	11.7kg	V0914	\$143.00
125mm	150mm	23kg	V0915	\$176.00
150mm	175mm	26.4kg	V0916	\$209.00
200mm	220mm	58.4kg	V0918	\$495.00

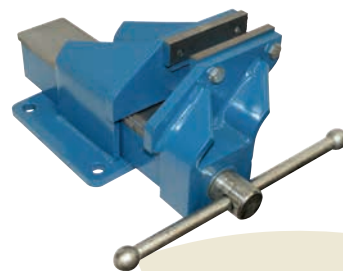

### 90° Angle Vice Clamps

- Jaws self-align to securely hold the same or different thickness materials always at 90°
- Clamps round, square, angle-iron, rectangle & channel sections

Max. Jaw Opening	Max. Jaw Height	Max. Jaw Length	Weight	CODE	inc GST
60mm	35mm	60mm	5kg	V099	\$99.00
100mm	60mm	90mm	12kg	V100	\$132.00
100mm	60mm	90mm	25kg	V101	\$275.00



### Blacksmiths Cast Steel Anvil

- 117R
- 680 x 200 x 195mm (L x W x H)
- Tooling with 3/4" and 7/8" shanks can be housed in the anvil
- 20mm square/round holes
- Weight 79.16Kg

CODE	inc GST
A020	\$759



## TOGGLE CLAMPS

### Toggle Clamps - Vertical TOOLMASTER

- KL-102B**
- Holding capacity: 100kg
  - Handle moves: 65°
  - Bar moves: 90°
  - Weight: 360g

**C1001**

**\$14<sup>30</sup>**  
inc GST



- KL-12130**
- Holding capacity: 227kg
  - Handle moves: 65°
  - Bar moves: 100°
  - Weight: 360g

**C100**

**\$17<sup>05</sup>**  
inc GST



- MP-12265**
- Holding capacity: 340kg
  - Handle moves: 58°
  - Bar moves: 105°
  - Weight: 700g

**C0999**

**\$22**  
inc GST



- MP-10247**
- Holding capacity: 450kg
  - Handle moves: 70°
  - Bar moves: 135°
  - Weight: 1.25kg

**C0998**

**\$30<sup>25</sup>**  
inc GST



### Toggle Clamps - Horizontal TOOLMASTER

- KL-201C**
- Holding capacity: 100kg
  - Handle moves: 87°
  - Bar moves: 79°
  - Weight: 360g

**C1003**

**\$14<sup>30</sup>**  
inc GST



- KL-225D**
- Holding capacity: 250kg
  - Handle moves: 65°
  - Bar moves: 90°
  - Weight: 360g

**C1005**

**\$17<sup>05</sup>**  
inc GST



- MP-20235**
- Holding capacity: 340kg
  - Handle moves: 50°
  - Bar moves: 85°
  - Weight: 600g

**C1006**

**\$22**  
inc GST



### Toggle Clamps - Straight Line TOOLMASTER

- KL-36020**
- Holding capacity: 220kg
  - Handle moves: 144.5°
  - Plunger travel: 29.3mm
  - Weight: 360g

**C1008**

**\$23<sup>10</sup>**  
inc GST



- MP-303-EM**
- Holding capacity: 450kg
  - Handle moves: 190°
  - Plunger travel: 50mm
  - Weight: 1kg

**C1009**

**\$30<sup>25</sup>**  
inc GST

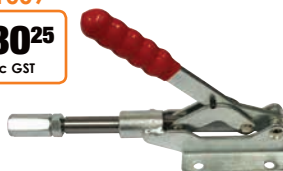

- MP-304-HM**
- Holding capacity: 680kg
  - Handle moves: 190°
  - Plunger travel: 62mm
  - Weight: 1.5kg

**C1010**

**\$36<sup>30</sup>**  
inc GST



- MP-36224M - Straight Line with Threaded Collar**
- Holding capacity: 690kg
  - Handle moves: 180°
  - Plunger travel: 67mm
  - Weight: 700g

**C1011**

**\$30<sup>25</sup>**  
inc GST



### Ratchet F Clamps TOOLMASTER

- Drop-forged sliding arm
- Hardened and tempered frame
- Rapid-action arm for quick tightening and repositioning
- M10 x 1.5mm threaded hole perfect for jigs or special attachments

Clamp L x W	CODE	inc GST
160 x 80mm	C0010	\$35.20
250 x 120mm	C0012	\$49.50
300 x 120mm	C0013	\$66.00
500 x 120mm	C0015	\$77.00

