

MILLS/MILL DRILLS & ACCESSORIES

Geared & Tilting Head Mills Drills

BF-16V Mini Opti-Mill Drill

- Electronic variable speed
- Dovetail column
- Head tilts ±90°
- 500W 240V motor
- Travels: (X) 220mm (Y) 160mm (Z) 210mm

M649

\$1,144
inc GST



3MT SPINDLE

ST-1620V STAND
M651

\$352
inc GST



Tilting Head Lock

HM-46 Mill Drill

- 3MT taper & tilting head
- Dovetail vertical slide
- 6 speeds (95-1600rpm)
- 730 x 210mm table size
- 1.5hp 240V motor
- Travels: (X) 475mm (Y) 195mm (Z) 450mm

M123

\$2,299
inc GST



Digital Tilting Head Gauge



MDS-H STAND
M135A

\$297
inc GST

HM-47 Mill Drill with DRO

- 3-Axis digital readout counter fitted with 2-Axis X & Y scales only
- Dovetail column
- Geared head drive
- Head tilts ±90°
- 2hp 240V motor
- Travels: (X) 540mm (Y) 185mm (Z) 410mm

M125D

\$3,795
inc GST

Stand Included



BF-20LV Opti-Mill Drill

- Electronic infinitely variable speed
- Dovetail column
- 2 speed gearbox
- Head tilts ±90°
- 850W 240V motor
- Travels: (X) 480mm (Y) 175mm (Z) 280mm

M650

\$1,815
inc GST

DOVETAIL
VERTICAL Z-AXIS



OPTIMUM®

ST-1620V
Stand Suits BF-16V & BF-20LV



ST-1620V STAND
M651

\$352
inc GST

HM-48 Mill Drill with DRO

- 3 Axis DRO system
- Dovetail column
- Geared head drive
- Head tilts ±90°
- 2hp 240V motor
- Travels: (X) 540mm (Y) 185mm (Z) 410mm

M126D

\$4,785
inc GST

Stand Included



MH-28V Mill Drill

- Electronic infinitely variable speed
- Dovetail column
- 2 speed gearbox
- Head tilts ±90°
- 1.1kW 240V motor
- Travels: (X) 430mm (Y) 220mm (Z) 355mm

M652

\$2,475
inc GST

CAST IRON TABLE
WITH T-SLOTS



OPTIMUM®

ST-28V
Stand Suits MH-28V



ST-28V STAND
M653

\$352
inc GST

Belt Drive

HM-32 Mill Drill

- 3MT spindle, 12 speeds
- 820 x 240mm work table
- 2hp, 240V motor
- Includes drill chuck, face cutter & tilting vice
- Travels: (X) 540mm (Y) 190mm (Z) 410mm

M121

\$1,925
inc GST



MDS-H STAND
M135A

\$297
inc GST

Coolant Pumps - Almost Any Application

- Submersible 130mm leg type only
- Submersible 180mm leg type only (P230)
- High-tensile cast iron housing
- Non-corrosive plastic impellers

CODE	P232	P233	P230
Discharge at 2M lift	20ltrs/min	20ltrs/min	60ltrs/min
Total Height (L)	285mm	285mm	350mm
Submerge Depth (L1)	130mm	130mm	180mm
PCD 4 mount holes	130mm	130mm	160mm
Outlet	Ø3/8"	Ø3/8"	Ø1/2"
Motor (hp / V)	1/8 / 240	1/8 / 415	1/4 / 415
Weight (kg)	6.1	6.1	13
inc GST	\$121	\$121	\$319



Collet Chuck Sets

- 8 piece collet & chuck set with collets covering metric & imperial



TM TOOLMASTER

Collet	Taper	Piece	Range (mm)	CODE	inc GST
ER32	3MT	6	7-6, 8-7, 10-9, 13-12, 16-15, 20-19	C922B	\$264
ER32	NT30	6	7-6, 8-7, 10-9, 13-12, 16-15, 20-19	C9245	\$264

Clamps Kits - 58 Piece

- Rolled threads
- Black oxide finish, tool steel, heat treated
- NOTE: (C098-C099) packed in a flat base wooden holder

Includes

- 6 x T-Slot nuts
- 6 x Flange nuts
- 4 x Coupling nuts
- 6 x Step clamps
- 12 x Step blocks
- 24 x Studs (4 each = 3", 4", 5", 6", 7", 8" length) C090, C091
- 24 x Studs (4 each = 75, 100, 125, 150, 175, 200mm length) C0955, C096A, C097, C098, C099
- 1 x Storage unit



C090 - C091 - C0955



C096A - C097



C098 - C099

Table Slot	Stud	CODE	inc GST
1/2"	3/8" UNC	C090	\$99
5/8"	1/2" UNC	C091	\$99
12mm	M10 x 1.5mm	C0955	\$99
16mm	M12 x 1.75mm	C096A	\$165
18mm	M16 x 2mm	C097	\$187
20mm	M18 x 2.5mm	C098	\$385
22mm	M20 x 2.5mm	C099	\$407

Power Feed Units ALIGN

M230

- Highest quality design & construction
- Suits longitudinal feed
- Variable speed drive

M227 / M229 / M2295

- Enamelled die-cast aluminium housing
- Robust construction
- 110V carbon brush motor



Axis	Suits	Speed Range	Torque	CODE	inc GST
X-Axis	Mill-Drill	0-270rpm	Max. 550 in/lb	M230	\$592.90
240V input with 110V output female plug				M240	\$143.00
X-Axis	Turret Mills	0-160rpm	Max. 650 in/lb	M227	\$649.00
Y-Axis	Turret Mills	0-160rpm	Max. 650 in/lb	M229	\$682.00
Z-Axis	Turret Mills	0-160rpm	Max. 650 in/lb	M2295	\$737.00

Rotary Tables

HV-4 / HV-6 / HV-8 / HV-10 / HV-12 / HV-14 / HV-16

- High level of accuracy
- Hardened and ground worm gear
- Gear ratio 90:1
- Vernier reading 10 seconds
- Table is graduated to 360°
- so one turn of the handle moves the table 4°
- Smooth operation for precision work
- Can be used horizontally or vertically



Made in Taiwan



R006



Model	Diameter (D)	Height (H)	Weight	CODE	inc GST
HV-4	110mm	80mm	7.5kg	R005	\$330.00
HV-6	150mm	80mm	14kg	R006	\$330.00
HV-8	200mm	105mm	30kg	R008	\$517.00
HV-10	250mm	115mm	40kg	R010	\$649.00
HV-12	300mm	135mm	60kg	R012	\$869.00
HV-14	350mm	140mm	95kg	R012A	\$1,089.00
HV-16	406mm	155mm	110kg	R012B	\$1,595.00

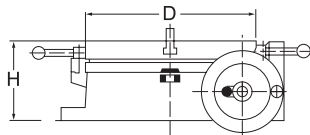

Dividing Heads - Semi-Universal

- Improved design with spindle spigot nose for a more accurate chuck mount
- The head can be swivelled from 10° below horizontal to 90° vertical
- Worm hardened and ground ratio between worm and worm wheel 40:1
- Dividing plates are designed to allow easy indexing on numbers 2, 3, 4, 6, 8, 12 & 24



Made in Taiwan

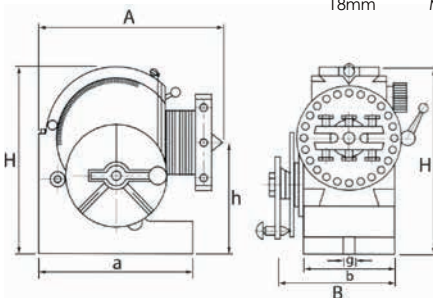

Model	Centre Height	A	B	H	h	a	b	g	Taper	Bore	Weight	CODE	inc GST
BS-0	100mm	189	140	173	100	160	91	13	2MT	18	20kg	D001	\$539
BS-1	128mm	293	156	220	128	207	114	16	3MT	20	38kg	D002	\$726

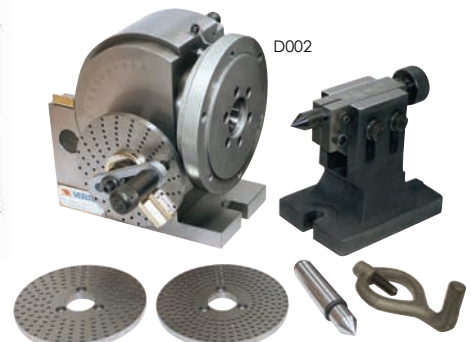

D002

Flanged Nuts & Clamp Kit Tee Nuts

TM TOOLMASTER

Flanged Nuts

- Sold in sets of 2

Thread	CODE	inc GST
1/2" UNC	N084	\$8.80
M10	N085	\$8.80
M12	N086	\$8.80
M16	N088	\$9.90



Clamp Kit Tee Nuts

- Sold in sets of 2

Slot	Stud	A	B	C	CODE	inc GST
5/8"	1/2" UNC	1"	11/32"	5/8"	C084	\$14.30
10mm	M8	16mm	6mm	12mm	C085	\$14.30
12mm	M10	18mm	7mm	14mm	C085A	\$14.30
14mm	M12	22mm	8mm	16mm	C086	\$14.30
16mm	M12	25mm	8mm	16mm	C087	\$14.30
18mm	M16	28mm	11mm	20mm	C088	\$17.05

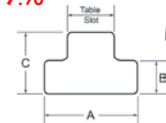

K-Type Milling Vices

- Jaws hardened & ground alloy steel
- Graduated swivel base with large, easy-to-read division
- All working surfaces, such as top & bottom of bed, jaw plates & base, are precision ground square & parallel

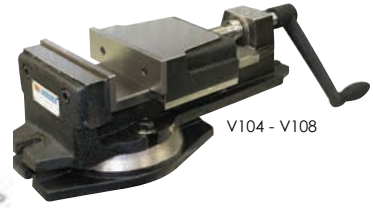
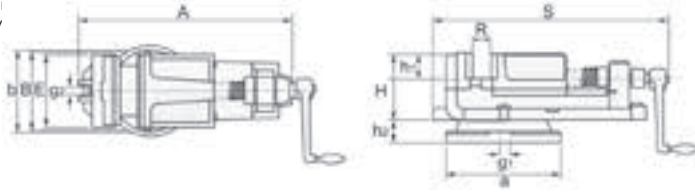

Size (mm)	Open (mm)	A (mm)	B (mm)	E (mm)	H (mm)	R (mm)	S (mm)	a (mm)	b (mm)	h1 (mm)	h2 (mm)	g1 (mm)	g2 (mm)	Weight kg	CODE	inc GST
63.5	51	200	70	68	70	51	260	98	75	30	25	12	12	5.7	V112	\$99
100	62	267	106	100	75	62	295	160	114	30	25	13	13	11	V104	\$154
127	80	345	128	125	98	80	370	208	150	37	30	12	12	18	V105	\$209
152	112	421	160	150	105	112	462	245	175	40	40	16	16	30	V106	\$242
203	146	576	215	200	144	146	620	340	230	58	45	18	18	55	V108	\$429

TM TOOLMASTER



3 Way Angle Milling Vices

Angles can be set in 3 planes:

1. Swivel 360° around the base
2. The vice can be elevated through 90° from horizontal to vertical
3. Tilts 45° from side to side

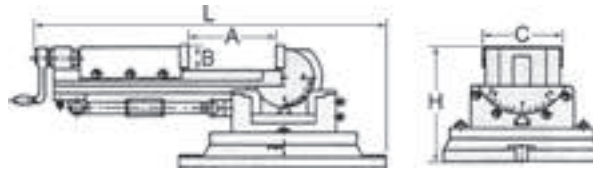

Size	A	B	C	H	L	Weight kg	CODE	inc GST
75	82	35	75	150	280	11.5	V113	\$363
125	95	45	125	210	340	28	V115	\$396



Face Mill Cutters - Positive Rake

- Use carbide inserts (ISO) TPKN1603 (L0661) or TPMN1603 (L066)
- Use carbide Inserts (ISO) TPKN2204 (L069) - M503 & M504
- Suitable for steel, cast iron & non-ferrous metals
- Includes lock key for insert

TM TOOLMASTER

Cutter	Insert Qty	Bore	CODE	inc GST
Ø50mm	3	22mm	M510	\$99.00
Ø63mm	4	27mm	M511	\$110.00
Ø75mm	5	27mm	M512	\$121.00
Ø100mm	6	32mm	M513	\$165.00
Ø125mm	8	40mm	M503	\$396.00
Ø160mm	10	40mm	M504	\$522.50



NOTE: Inserts not included

ISO Tungsten Carbide Inserts

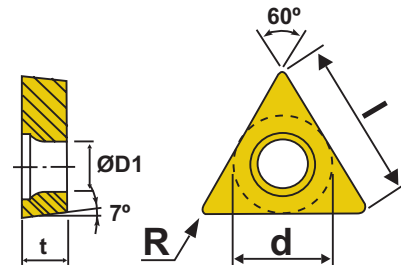

MILLING DIAGRAM

Milling Inserts (PACK OF 10)

ISO	Grade	l (mm)	d (mm)	t (mm)	R (mm)	CODE	inc GST
SEKT 1204-AFEN-S	PR1225	12.7	12.7	4.76	1.7 Flat	L065	\$180.40
TPMN 160308	PR1255	16.5	9.925	3.18	0.8	L066	\$107.80
TPKN 2204-PDTR	PR1225	22	12.7	4.76	-	L069	\$192.50
APMT 103504-PDER-H	ACZ330	-	9.75	3.3	0.4	L059	\$152.35

Face Mill Arbors

- Material: SCM-21
- Hardness: HRC 50° - 55°

TM TOOLMASTER

Size mm	Draw Bar	CODE	inc GST
MT3 x Ø22	1/2"	M562	\$60.50
MT3 x Ø27	1/2"	M563	\$60.50
NT30 x Ø22	12mm	M540	\$60.50
NT30 x Ø27	12mm	M542	\$60.50
NT30 x Ø32	12mm	M544	\$60.50
NT30 x Ø40	12mm	M545	\$71.50



Low Volt Halogen & LED Lamps

- (L283)
- Magnetic base
 - Transformer included

Model	Type	Input Voltage	Watt	CODE	inc GST
HL-35T	Flexible Lamp - Halogen	240V	35W	L283	\$93.50
HL-35LT	Flexible Lamp - 3 x LED	240V	3W	L2814	\$154.00
HL-55	Swivel & Pivot Arm - Halogen	12V	55W	L284	\$99.00
HL-55T	Swivel & Pivot Arm - Halogen	240V	55W	L285	\$143.00

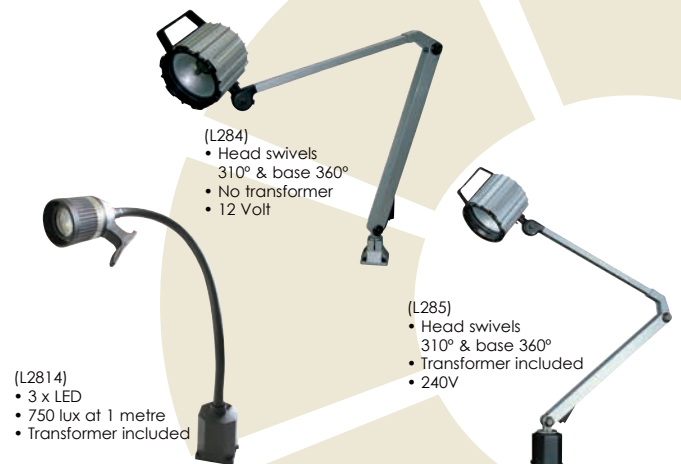

- (L2814)
- 3 x LED
 - 750 lux at 1 metre
 - Transformer included

- (L285)
- Head swivels 310° & base 360°
 - Transformer included
 - 240V



alcock
tools that stand the test of time

Slot Drill Set

- Manufactured from HSS M35 5% cobalt bright finish screwed shank
- Two Flute



5 Piece Metric
6, 8, 10, 12, 16mm

\$107.80 inc GST (M3351)

HSS End Mill Set

- Manufactured from HSS M35 5% cobalt bright finish screwed shank
- Four Flute



5 Piece Metric
6, 8, 10, 12, 16mm

\$107.80 inc GST (M3352)

Carbide End Mill Set

- Manufactured from micro fine solid carbide
- Bright finish
- Plain shank



4 Piece Metric
6, 8, 10, 12mm

\$204.60 inc GST (M337)

HSS Slot Drill & End Mill Set

- Manufactured from HSS M2
- Plain shank
- Includes 5 end mills & 5 slot drills

10 Piece Metric
6, 10, 12, 16, 20mm

\$139.15 inc GST (M3301)

10 Piece Imperial
1/4", 3/8", 1/2",
5/8", 3/4"

\$139.15 inc GST (M3321)



Counterbore Drill Set

- 6 piece set
- HSS M35 bright finish
- Plain Shank
- Range: M3, M4, M5, M6, M8, M10



\$145.20 inc GST (M3381)

Radius Cutter Set

- 4 piece set
- High Grade HSS M35 bright finish
- Radius sizes: 4, 5, 6, 8mm
- Shank sizes: 12, 16, 16, 20mm



\$145.20 inc GST (M3391)

Ball Nose Cutter Set

- 5 Piece
- HSS M35 5% cobalt bright finish
- Plain shank
- 2 Flute
- Shank sizes: 6, 10, 10, 12, 16mm



5 Piece Metric
6, 8, 10, 12, 16mm

\$107.80 inc GST (M3355)

Industrial Countersink Sets

- 4 piece
- HSS M2 bright finish
- Cross hole type
- Range: Ø2-5, 5-10, 10-15, 15-20mm
- Angle 45°



\$71.50 inc GST (D1051)

- 6 piece
- HSS M2 bright finish
- 3 flute type
- Ranges: Ø1.5-6.3, 6.3-8.3, 8.3-10.4, 10.4-12.4, 12.4-16.5, 16.5-20.5mm



\$82.50 inc GST (D1061)

Combination Tap & Drill Set

- 7 piece set
- HSS M2 bright finish
- M3, M4, M5, M6, M8, M10mm
- Includes Hex snap-on shank for hand drill



\$66.55 inc GST (T0191)

Centre Drill Set

- 5 piece set
- Industrial quality
- HSS M2 bright finish
- No. 1, 2, 3, 4, 5



\$47.30 inc GST (D508)

Sheet Metal Step Drill Set

- 3 piece set
- HSS M2 bright finish
- Ø4-12 x 1mm,
- Ø6-20 x 2mm,
- Ø6-30 x 2mm



\$82.50 inc GST (D1071)

Individual Engineers Files

- 250mm length files
- Cushion grip handle



Shape	Cut (Teeth)	CODE	inc GST
Flat	Coarse	F120	\$17.05
Flat	Second Cut	F121	\$17.05
Flat	Smooth	F122	\$17.05
Half Round	Coarse	F124	\$17.05
Half Round	Second Cut	F125	\$17.05
Half Round	Smooth	F126	\$17.05
Round	Coarse	F127	\$17.05
Round	Second Cut	F128	\$17.05
Round	Smooth	F129	\$17.05

HSS Hole Saw Set

- Bi-Metal high speed steel
- 11 Sizes: 19, 22, 25, 32, 35, 38, 44, 51, 57, 64, 76mm
- Includes 3/8" & 1/2" arbor shank
- Pilot drill



\$110 inc GST (D102)

Carbide Tipped Hole Saw Set

- 8 Piece set
- Heat resistant carbide teeth for long life
- Suitable for stainless steel, steel, fibre glass, and glass reinforced products
- Range: 16, 20, 22, 25, 28, 30, 32, 35mm



\$99 inc GST (D108)

2MT Drill Set

- 100% HSS flute length
- Sizes: 14.5, 15, 16, 17, 18, 19, 20, 21, 22, 23mm



\$209 inc GST (D122)

Reduced Shank Drill Set

- 8 piece piece
- High speed steel M2 grade 100% flute length
- 118° point angle

Metric Range: 13 - 25mm
Shank Ø13mm

\$154 inc GST (D1171)

Imperial Range 9/16" - 1"
Shank Ø1/2"

\$154 inc GST (D1181)



Industrial Drill Sets

- Precision ground flutes
- HSS M2 bright finish
- 135° split point centre

25 Piece Metric
1 - 13mm (x 0.5mm)

\$99 inc GST (D1272)

29 Piece Imperial
1/16" - 1/2" (x 1/64")

\$104.50 inc GST (D1282)



Industrial Jobber Drill Packs

- Industrial M2 grade high speed steel
- Ground flute & split point
- 135° ground drill point

Ø(mm)	Qty	CODE	inc GST	Ø(mm)	Qty	CODE	inc GST
1.0	10	D8150	\$11.00	7.0	10	D8162	\$55.00
1.5	10	D8151	\$11.00	7.5	10	D8163	\$63.80
2.0	10	D8152	\$11.00	8.0	5	D8164	\$27.50
2.5	10	D8153	\$11.00	8.5	5	D8165	\$31.35
3.0	10	D8154	\$15.95	9.0	5	D8166	\$35.75
3.5	10	D8155	\$15.95	9.5	5	D8167	\$40.15
4.0	10	D8156	\$18.70	10.0	5	D8168	\$44.55
4.5	10	D8157	\$23.10	10.5	5	D8169	\$49.50
5.0	10	D8158	\$28.05	11.0	5	D8170	\$55.55
5.5	10	D8159	\$32.45	11.5	5	D8171	\$61.05
6.0	10	D8160	\$38.50	12.0	5	D8172	\$68.20
6.5	10	D8161	\$46.75	12.5	5	D8173	\$73.70

Morse Taper Shank Drills

- High Speed Steel
- Made to DIN345 standard

Ø(mm)	Taper	CODE	inc GST	Ø(mm)	Taper	CODE	inc GST
12.5	1MT	D300	\$15.95	22.0	2MT	D319	\$36.30
13.0	1MT	D301	\$18.15	22.5	2MT	D320	\$36.30
13.5	1MT	D302	\$18.15	23.0	2MT	D321	\$38.50
14.0	1MT	D303	\$22.00	23.5	3MT	D322	\$43.45
14.5	2MT	D304	\$22.00	24.0	3MT	D323	\$43.45
15.0	2MT	D305	\$22.00	24.5	3MT	D324	\$43.45
15.5	2MT	D306	\$22.00	25.0	3MT	D325	\$47.30
16.0	2MT	D307	\$22.00	25.5	3MT	D326	\$47.30
16.5	2MT	D308	\$22.00	26.0	3MT	D327	\$50.60
17.0	2MT	D309	\$24.20	26.5	3MT	D328	\$50.60
17.5	2MT	D310	\$24.20	27.0	3MT	D329	\$54.45
18.0	2MT	D311	\$26.40	27.5	3MT	D330	\$54.45
18.5	2MT	D312	\$26.40	28.0	3MT	D331	\$56.65
19.0	2MT	D313	\$26.40	28.5	3MT	D332	\$56.65
19.5	2MT	D314	\$26.40	29.0	3MT	D333	\$60.50
20.0	2MT	D315	\$30.25	29.5	3MT	D334	\$60.50
20.5	2MT	D316	\$30.25	30.0	3MT	D335	\$72.60
21.0	2MT	D317	\$34.10	30.5	3MT	D336	\$72.60
21.5	2MT	D318	\$34.10	31.0	3MT	D337	\$83.60

Industrial Drill Set

- Precision ground flutes
- HSS M2 bright finish

51 Piece Metric
1 - 6mm (x 0.1mm)

\$126.50 inc GST (D1285)

